

Soils Map

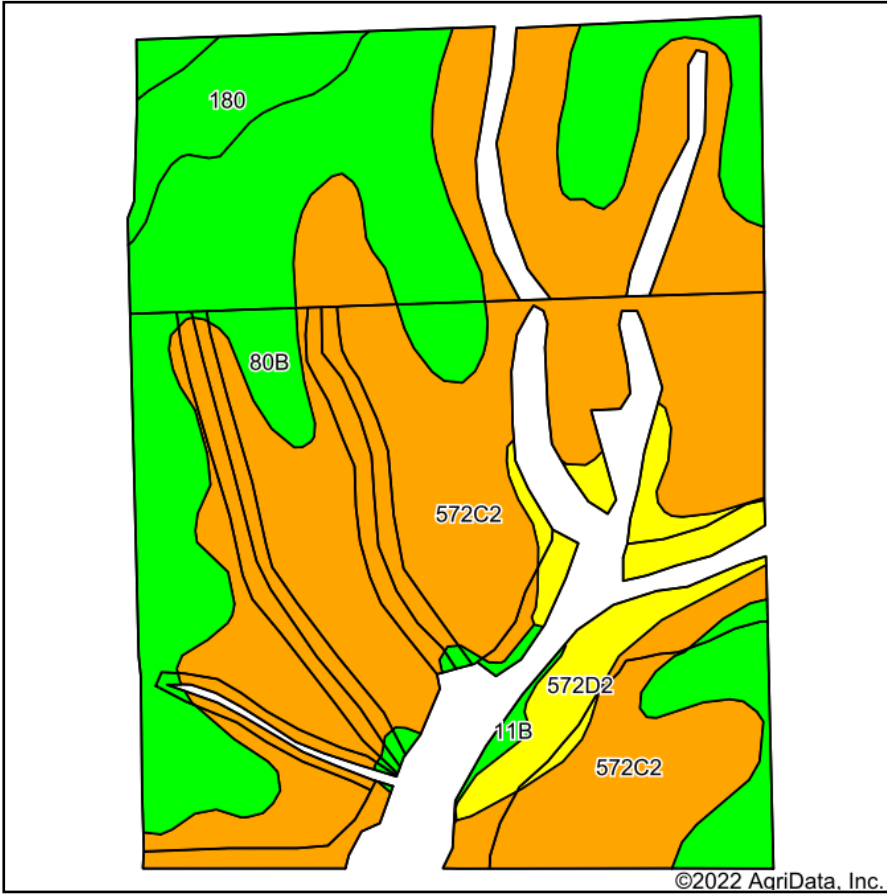

Soils data provided by USDA and NRCS.

©2022 AgriData, Inc.

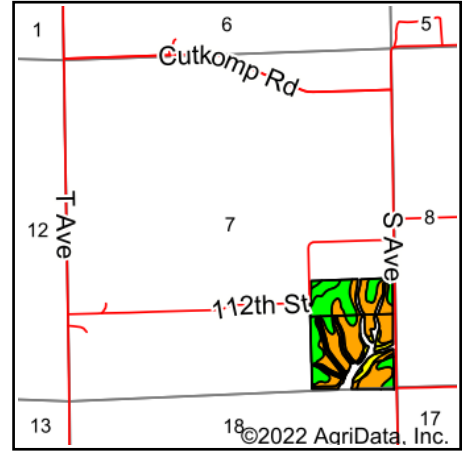

State: **Iowa**
 County: **Louisa**
 Location: **7-74N-4W**
 Township: **Columbus City**
 Acres: **44.43**
 Date: **4/11/2022**







Maps Provided By:

 CUSTOMIZED ONLINE MAPPING
 © AgriData, Inc. 2021 www.AgriDataInc.com



Area Symbol: IA115, Soil Area Version: 25

Code	Soil Description	Acres	Percent of field	CSR2 Legend	Non-Irr Class *c	CSR2**	CSR	
572C2	Inton silt loam, 5 to 9 percent slopes, moderately eroded	25.57	57.6%		IIIe	69	57	
80B	Clinton silt loam, 2 to 5 percent slopes	13.91	31.3%		Ile	80	80	
572D2	Inton silt loam, 9 to 14 percent slopes, moderately eroded	2.74	6.2%		IIIe	44	47	
180	Keomah silt loam, 0 to 2 percent slopes	1.76	4.0%		IIw	82	76	
11B	Colo-Ely complex, 0 to 5 percent slopes	0.45	1.0%		IIw	86	68	
Weighted Average						2.64	71.6	64.4

**IA has updated the CSR values for each county to CSR2.

*c: Using Capabilities Class Dominant Condition Aggregation Method
 Soils data provided by USDA and NRCS.